



The Copyright of this drawing belongs to T C Matthew Chartered Architect and shall not be used or reproduced in any form without its express permission. The moral right of the author is hereby asserted.

Notes



Client

Russell Clark Projects Ltd.

Project

Rose Revealed

Elizabethan Theatre Remains Site Interpretation

Services:	Architect Support to Museum Designer
Contract:	—
Value:	—

T C Matthew
Chartered Architect
92 London Road
Southend-on-Sea
Essex. SS1 1PG
www.tcmca.co.uk
Tel: 07505 983394

T C Matthew
Chartered
Architect

GOLDEN AGE
'ROOM'

A THEATRE IN TIME

PRESENT AGE
'ROOM'

PARK STREET

Rose Court, stair case

emergency exit 12

+3500

+3,500

UP +1,800 below

seating below

Void

ENTRANCE

+3,500

ROSE ALLEY

VOID TO BELOW

+3,700

+4,070

double height, object & projection board

10

stage below

+4,070

+3,580±



APPROXIMATE -BASED
ON THE EXISTING
DRAWINGS.
SUBJECT TO FURTHER
SITE SURVEY.



Rose Revealed
Street / upper Level
Plan
Proposed
1:100 @ A3, 1:200 @ A4
May. 2012

HEM
ARCHITECTURE
with
Austin-Smith:Lord

TZMCA
MARK-UP
29.11.2013

-  floor area
-  void to below
-  display area incl. shop display
- 1. main entrance
- 2. reception / info counter
- 3. mediatheque / educational facility
- 4. display
- 5. ramp to lower level
- 6. stair to lower level
- 7. platform lift
- 8. WC (disabled)
- 9. storage
- 10. display zone (double height)
- 11. emergency exit
- 12. existing doors (to remain)

← PRESENT & FUTURE

HISTORY

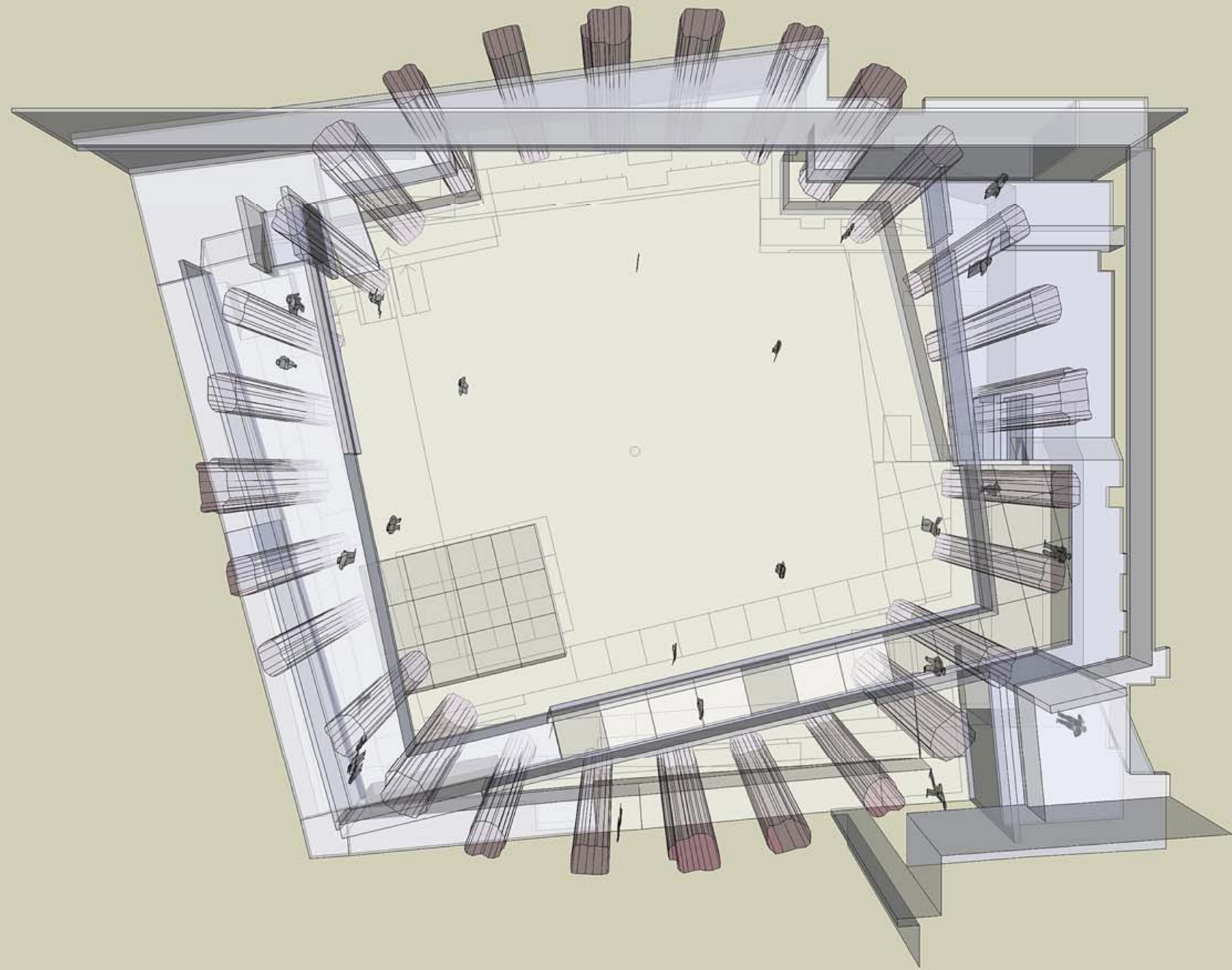





The Rose Revealed

Interpretation Design Report



act II: rising action

Traditional in theatre during the second act, 'Rising Action,' the drama introduced in Act I is complicated by conflicts and obstacles designed to keep the protagonist from reaching his or her goal. The Rose Playhouse has weathered countless challenges, both in the past and more recent times, and its mere survival is a testament to the tenacity of the site and the people who value it.

From the early 17th century, when The Rose Playhouse was shut due to economic circumstance and then reduced to foundation level, through continuous development in the late 20th century The Rose has survived although the buried archeology is extremely fragile, and requires constant monitoring and vigilance.

Act II puts conservation at the heart of The Rose Playhouse story, as without it there would be no monument. The action explains the geology of the Thames on which The Rose, Southbank's first theatre, was built and the earlier history of the site. The unstable and waterlogged nature of the ground and the fluctuating water table underneath the site has helped to preserve the remains, yet also dictate that they must remain buried beneath the floor.



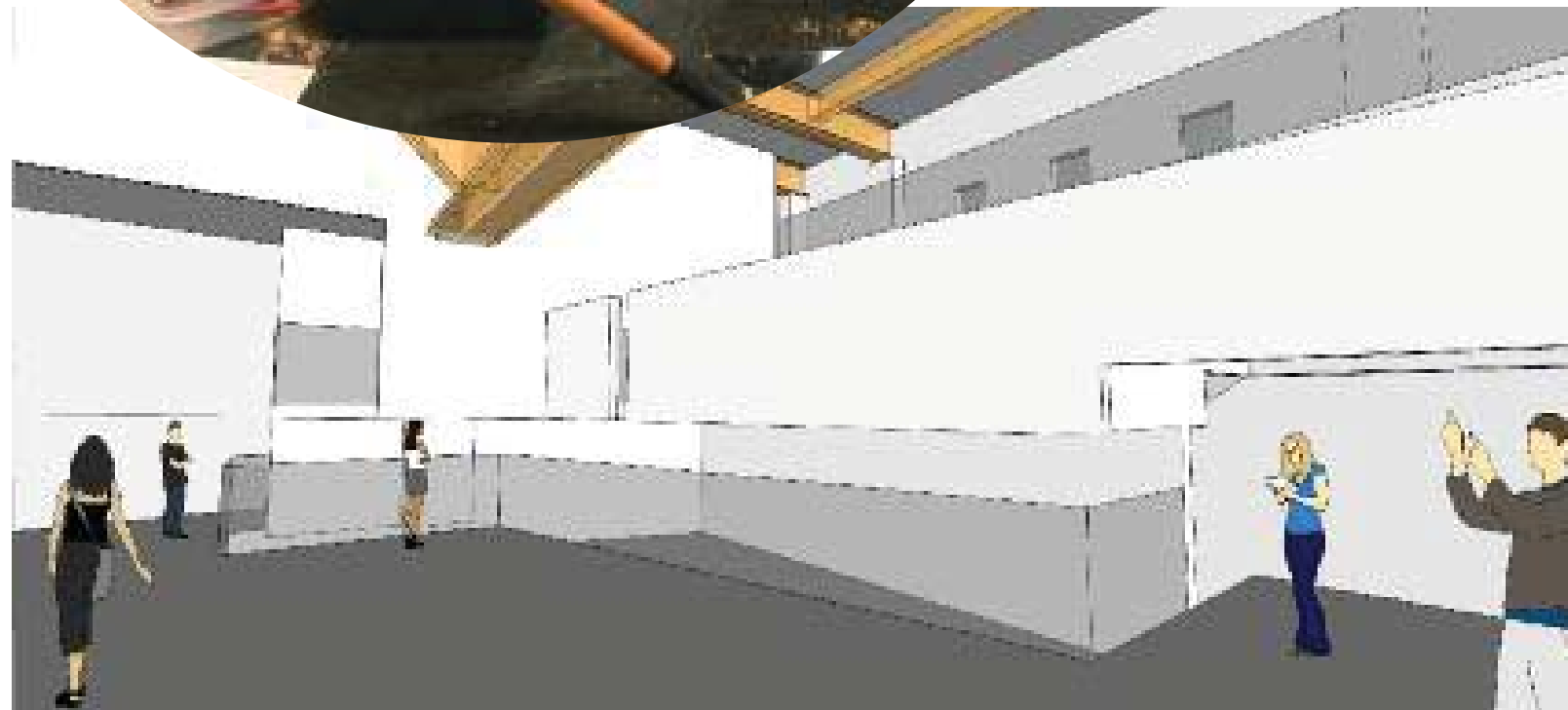

act V: resolution

The final act of our Elizabethan drama is an appeal for the audience to become involved, to attend a performance, to create a performance. It is an appeal for the visitor to return, which today might even be an appeal for money in the form of a membership or a donation.

In our final act we want to enable local people to become involved in presenting the site to the public, fostering a sense of community ownership and stewardship which will ensure the ongoing survival of The Rose.

We also consider any post-visit interaction with the site as part of this section. Evaluation and feedback will be important to achieving success in the long term allowing further evolution in line with the needs of visitors and The Heritage Lottery Fund's expectations.